

INTELLIGENT FURNITURE SMART CODE LOCK

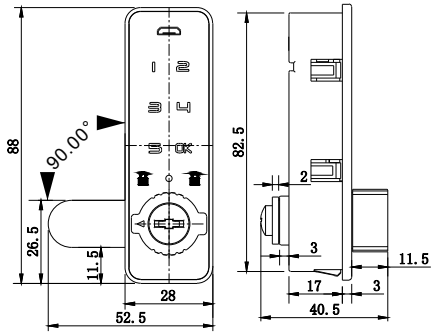

USER MANUAL

USER INSTRUCTION

Feature

1. Access Control: password (Code)
2. Two password: master code and user code
3. Programming 1-10 digit password (Code)
4. Turning Knob
5. Backup mechanical key
6. Led light indicator with visual signal
7. Widely used in drawer, cabinet, wardrobe etc.

Unlock the door

- Enter the valid password (master code or user code) then press "OK"
- Two beeps, the light in green, turn the knob clockwise, then pull the door open

Note:

- ☆ Three beeps if wrong password
- ☆ If password forgotten, open the door by backup key.

Lock the door

- Push the door closed
- Turn the knob counterclockwise to lock the door

Setting

1. Change master code

- Press "5" for two seconds, red light on
- Enter the old master code then "OK"
- Two (2) beeps, enter "2" then "OK"
- Two (2) beeps, enter any code less than 10 digit then "OK", twice
- Two (2) beeps, red light off, the master code changed.

2. Change user code

- Press reset button on the back of ceiling panel, red light on
- Two (2) beeps, enter any code less than 10 digit then "OK", twice
- Two (2) beeps, red light off, the master code changed.

Note

- ☆ Factory Setting: master code (5-4-3-2-1-5), user code (1-2-3-4)
- ☆ Make sure the belongings security, please change the maser code and password firstly before using.

Initialization

- Press reset button for 4 seconds, two beeps then release
- System initialized. The master code is 5-4-3-2-1-5, user code: 1-2-3-4.

Low Battery Warning

- Six (6) beeps with red light flashing 6 times after opened indicates low battery, please replace the battery immediately. If the battery can't open the door, connect outer power supply by USB port to open the lock.

COMPONENT



INSTALLATION

SINGLE BOARD DOOR

1. Cut a slot 83X20mm according picture 1, the distance is 18mm between the slot center and door wall

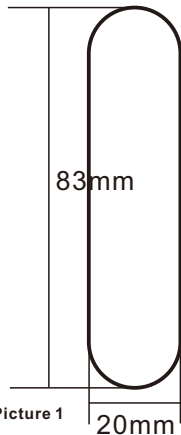

2. Make and weld a support for battery case, the distance no more than 80mm to the slot, and no less than 5mm in height. Drill two hole $\Phi 2\text{mm}$ (tapping M2.5) in the support, the center distance is 15.80mm.
3. Fix up the ceiling panel into the slot, then fix up the cam by screw M5X5
4. Fix up the battery case on the support by screw M2.5X6
5. Connect the wire into battery case.

Wire Connection

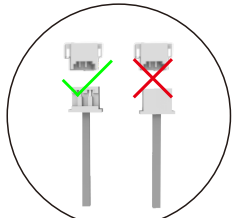

SINGLE BOARD

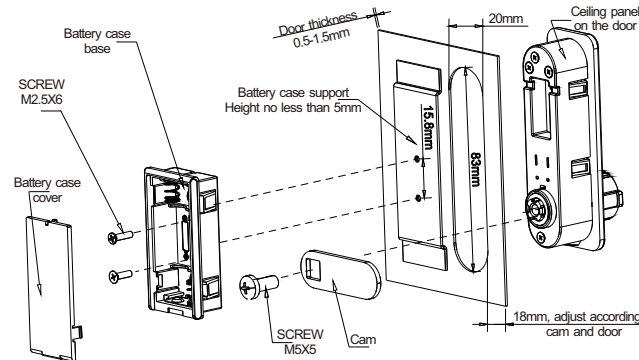

DOUBLE BOARD DOOR

1. Cut a slot 83X20mm according picture 2, the distance is 18mm between the slot center and door wall (Thickness of double board is 13-17MM)
2. Cut a slot 54.5X26mm according picture 3, the distance no more than 80mm to the slot
3. Fix up the ceiling panel into the slot, then fix up the cam by screw M5X5
4. Fix up the battery case into the slot
5. Connect the wire into battery case

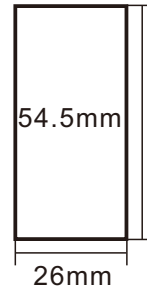
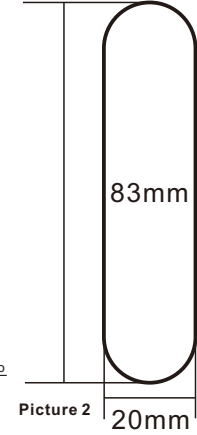

Wire Connection

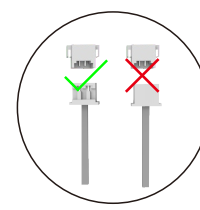

DOUBLE BOARD

