

USER MANUAL

SMART LOCK

Fingerprint
Password
RFID Card
Emergency Key
Wi-Fi

The default Administrator password is 123456.
Please change to new Administrator password.
For your safety, do not use consecutive or repetitive numbers.

PTMP7152ONTA REV.03

Safety Cautions

- The manual should be read thoroughly before operating the product.
- For security purposes, the password should be changed on a regular basis.
- When the batteries are inserted in reverse positions, it may result in liquid leakage or rupture.
- When the batteries are flat, all the batteries should be replaced.
- Please replace with new batteries, not used ones.
- Do not install, disassemble or repair without the assistance of a product repair technician.
- Use a soft and dry cloth to clean the product.
- Do not press or insert the buttons with awls or pins.
- Do not use the product for any purpose other than a digital door lock.
- Do not let water get into the product.
- This product is for household use, and its normal functioning cannot be guaranteed in any other environment or setting.
- Do not subject the product to any severe impact.

Product Specification

Installation condition	Door thickness	40-70 mm
Opening method	Password	4-12 digits up to 4 passwords may be registered.
	RFID Card	Up to 100 RFID cards may be registered.
	Fingerprint	Up to 100 fingerprints may be registered.
Rated voltage	DC 6V	LR6 1.5V AA alkaline battery
Emergency power supply	DC 9V	9V Battery (6LF22) (sold separately)
Sensing high temperature	Temperature sensor	72°C±5°C (Laboratory environment) 62°C±5°C (General environment)
Material	Outdoor body	Al, Zn, PC
	Indoor body	Zn, PC

The contents of this user guide are subject to change without prior notice in order to enhance the performance of the product.

Deadbolt Alarm

While the deadbolt unlocks/locks the door, if it doesn't fully extend or withdraw, an alarm will sound (3 beeps).

- If the alarm doesn't stop or the product does not function properly, re-adjust the position of the lock so there is no interference of the deadbolt.
- Please contact our customer service if this problem repeats often.

Low Battery Alarm

If the lock operates normally, but sounds an alarm with the low battery LED notification, the batteries need to be replaced. Make sure you replace all 8 batteries at once.

- When the batteries are flat, replace all batteries.
- Do not mix batteries with different manufacturers or brands.

High Temperature Alarm

When the lock senses a high temperature (62°C ± 5°C) with a risk of fire, an alarm will sound in high volume to acknowledge the danger and the door will be automatically unlocked for safe exit.

- If the indoor body is exposed to direct sunlight, it may cause the high temperature alarm to go off.
- Even under Forced Lock Mode, the door will automatically unlock.

Prank Alarm and 1-minute Lock Down

When an unregistered password, RFID card or fingerprint is entered incorrectly 5 consecutive times, the lock will not function for 1 minute and an alarm will sound.

- Try again after the 1 minute lockdown has been disabled.

Names of Individual Parts (Outdoor Body)

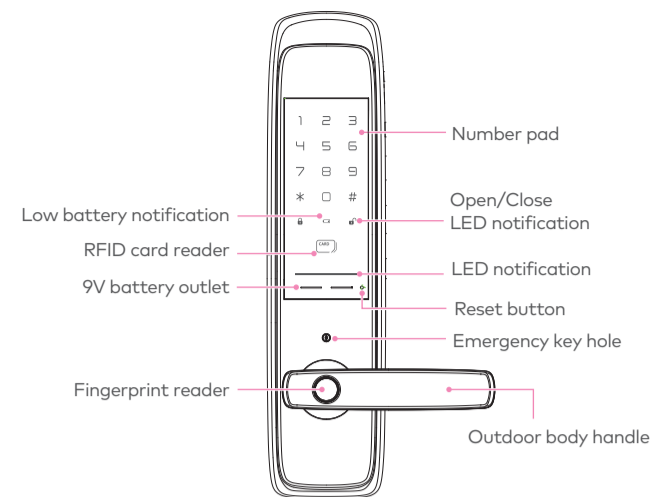

Names of Individual Parts (Indoor Body)

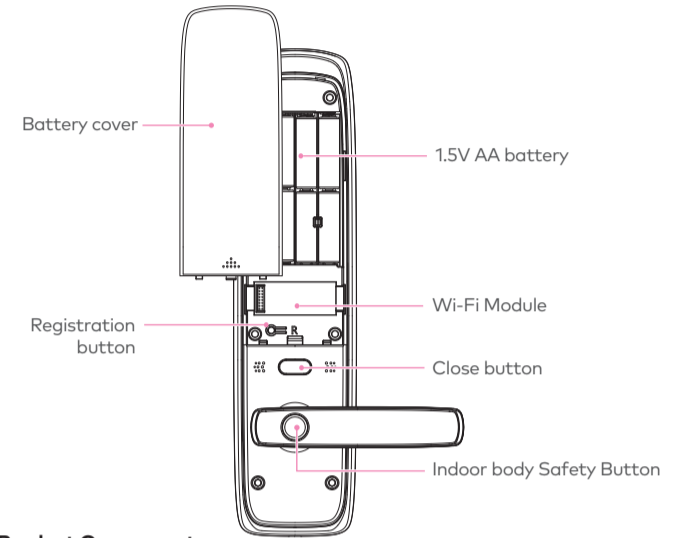

Product Components

* The product components may change depending on the installation environment.

RFID Card	Screws	Mortise
User manual	Emergency key	Mortise shaft
Installation manual	Striker	Mortise shaft fixing pin
Drilling guide	Wi-Fi Module	Dust box
'AA' Batteries (LR6)		

Sold separately

Video door phone module
Remote control / Receiver module

Enter the Registration Mode

- Not inputting anything for 10 seconds will cancel the authorisation.
- An error will occur if you enter a password with less than 6 digits or more than 12 digits and the authorisation will be cancelled.
- When entering an administrator password, pressing the [*] button will reset the entry.
- Pressing the [#] button without any entry or pressing the [Register] button during authorisation will cancel the authorisation.

Authorise with an Administrator Password

- Press the [Register] button
- Input an administrator password
- Press the [#] button

[R] Admin Password [#]

Authorise with an Administrator RFID Card

- Press the [Register] button
- Put an administrator RFID card on the reader

[R] [CARD]

* Default password : 123456

For all settings such as changing the password or registration of the card/fingerprint and deletion of any authentication, you must enter "Master Mode" first and follow up the next step. The initial master mode is set to "R Button Input - Initial Password (123456) - #". Please change the administrator password and register the administrator card to set the master mode before using it.

Register Password

- Make sure to register a RFID card while the door is open.

Change Administrator Password * Default password: 123456

- Enter the **Registration Mode**
- Press the [0] button
- Enter a 6 to 12 digits administrator password, and press the [#] button

[R] Admin Password [#]
OR
[R] [CARD]

0

Admin Password (6-12 digits) [#]

- The Administrator password cannot be identical to an existing user/one-time password.

Register a User Password

- Enter the **Registration Mode**
- Press the [1] button
- Enter a 4 to 12 digit user password, and press the [#] button

[R] Admin Password [#]
OR
[R] [CARD]

1

User Password (4-12 digits) [#]

- Repeating step 3 before the keypad lamp turns off will register another user password. (Up to four passwords can be registered.)
- The User password cannot be identical to an existing administrator/one-time password.

Register a User Password with an Address

- Enter the **Registration Mode**
- Address (1-4)
- Address
- Address
- User Password (4-12 digits)
- Address

1

Address (1-4)

#

User Password (4-12 digits)

#

- Repeating steps 2 and 3 before the keypad lamp turns off will register another user password. (Up to 4 passwords can be registered.)
- The User Password cannot be identical to an existing administrator/one-time password.

Register a One-time Password

- Enter the **Registration Mode**
- 4
- One-time Password (6 digit)
- #

- The One-time password cannot be identical to an existing administrator/user password.
- The One-time password will become invalid after using it to open the door.

- Not inputting anything for 10 seconds will cancel the registration.
- When entering an administrator, a user or a one-time password, pressing the [*] button will reset the entry.
- Pressing the [#] button without any entry or pressing the [Register] button during authorisation will cancel the authorisation.

Register an Administrator RFID Card

- Make sure to register a RFID card while the door is open.

- Enter the **Registration Mode**
- 0
- CARD

- Repeating step 3 before the keypad lamp turns off will register another administrator RFID card. (Up to 10 RFID cards can be registered)
- The Administrator RFID card cannot be identical to a user RFID card.

Register an Administrator RFID Card with an Address

- Enter the **Registration Mode**
- 0
- Address (1-10)
- #
- CARD

- Repeat step 2 and 3 before the keypad lamp turns off will register another administrator RFID card. (Up to 10 RFID cards can be registered)
- The Administrator RFID card cannot be identical to a user RFID card.

Register a User RFID Card

- Enter the **Registration Mode**
- 2
- CARD

- Repeating steps 2 and 3 before the keypad lamp turns off will register another administrator RFID card. (Up to 100 RFID cards may be registered)
- The User RFID card cannot be identical to an administrator RFID card.

Register a User RFID Card with an Address

- Enter the **Registration Mode**
- 2
- Address (1-10)
- #
- CARD

- Repeating steps 2 and 3 before the keypad lamp turns off will register another user RFID card. (Up to 100 RFID cards may be registered)
- User RFID card cannot be identical to an administrator RFID card.

- Not inputting anything for 10 seconds will cancel the registration.
- Pressing the [#] button without any entry or pressing the [Register] button during authorisation will cancel the authorisation.

Register Fingerprint

- Enter the **Registration Mode**
- 3
- finger print 3 times
- #

- If you repeat the first 3 steps before the 4rd, an additional user fingerprint will be registered. (Up to 100 can be registered)
- You can not register the same fingerprint.
- Registration will be cancelled if there is no input for 10 seconds.
- If you do not press the [*] button or the [Register] button during the registration process, registration will be cancelled.

- Up to 100 Fingerprints can be registered.

Enter the Deletion Mode

Authorise with an Administrator Password

- Press the [Register] button for 3 seconds
- Input an administrator password
- Press the [#] button

[R] Admin Password [#]
(for 3 seconds)

Authorise with an Administrator RFID Card

- Press the [Register] button for 3 seconds
- Put an administrator RFID card on the reader

[R] [CARD]
(for 3 seconds)

* Default password : 123456

- Not inputting anything for 10 seconds will cancel the authorisation.
- An error will occur if you enter a password with less than 6 digits or more than 12 digits password the authorisation will be cancelled.
- When entering an administrator password, pressing [*] button will reset the entry.
- Pressing the [#] button without any entry or pressing [Register] button during authorisation will cancel the authorisation.

Delete a User Password

- Enter the **Deletion Mode**
- 1
- Address (1-4)
- *

Delete all User Passwords

- Enter the **Deletion Mode**
- 1
- #
- 3 seconds

Delete a One-time Password

- Enter the **Deletion Mode**
- 4
- *

Delete an Administrator RFID Card with an Address

Delete an administrator RFID card with an address

1. Enter the **Deletion Mode**
- 2.
- 3.
- 4.

Delete all Administrator RFID Cards

1. Enter the **Deletion Mode**
 - 2.
 - 3.
- 3 seconds

Delete a User RFID Card with an Address

1. Enter the **Deletion Mode**
- 2.
- 3.
- 4.

Delete a User RFID Card

1. Enter the **Deletion Mode**
- 2.
- 3.

Delete all User RFID Cards

1. Enter the **Deletion Mode**
 - 2.
 - 3.
- 3 seconds

Delete Fingerprints and Address

1. Enter the **Deletion Mode**
- 2.
- 3.
- 4.

Delete all Fingerprints

1. Enter the **Deletion Mode**
 - 2.
 - 3.
- 3 seconds

Opening the Door From Outside (With Fingerprint)

Scan the registered fingerprint against the reader.



Opening the Door From Outside (With RFID Card)

Automatic Detection Mode

Tag the registered RFID card against the reader.



Manual Detection Mode

Touch the number pad and when the light on the number pad lights up, tag the RFID card reader with a registered RFID card.



- Press the [#] button before scanning the RFID card to enter silently.
- Default setting is automatic detection mode.

Opening the Door From Inside

Safety Handle Disabled

Press the handle downwards to open the door.



Safety Handle Enabled

Push the safety button and press the handle downwards to open the door.



- If the door is not opened after unlocking the door, it will automatically re-lock within 7 seconds.

Opening the Door From Outside (Emergency Key)

Use the emergency key behind the outdoor body handle and turn right/left to unlock the door.



Open the Door From Outside with a Password

In General Authorisation Mode

- 1.
 - 2.
 - 3.
- administrator password
 - user password
 - one-time password

- If you enter the [*] button before step 2, the door will be opened silently.
- A series of virtual numbers can be entered before or after step 2 while the virtual number function is activated to open the door.

In Double Authorisation Mode

- 1.
- 2.
- 3.
- 4.

- One-time password does not work under double authorisation mode.
- When the RFID card is not registered, double authorisation mode does not work. (Normal authorisation will be applied even if double authorisation is enabled.)
- Not inputting anything for 10 seconds will cancel the authorisation.
- Virtual number function can be used in order not to expose your passwords. (However, the length of the password plus the virtual number cannot exceed 21 digits, or it will result in an error.)
- 5 attempts allowed before the authorisation gets suspended for one minute. after that, you may try again.
- The Guest password will become invalid after using it to open the door.
- When the virtual number function is set and the virtual number (random number) is entered before or after the password, the door will open.

How to use the Safety button

How to enable Safety button

Use a hexagon L-wrench and turn the headless bolt on the side of the handle counter clockwise until the safety button pops out.

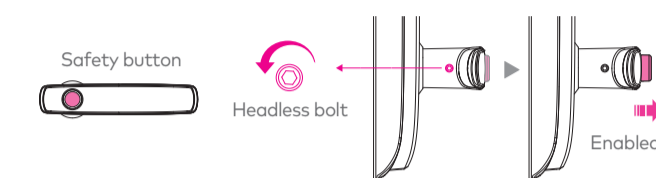

How to disable Safety button

Press the safety button while turning the headless bolt clockwise until it is fully tightened.

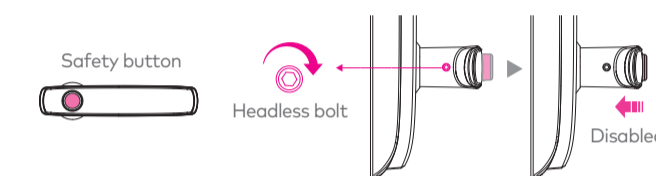

Locking the Door From Inside

Automatic Lock Mode

When the door is closed, it will automatically lock within 2 seconds.

Manual Lock Mode

Press the [Close] button on the indoor body in order to lock the door.

CLOSE

Locking the Door From Outside

In auto lock mode

The door will automatically be locked in 2 seconds after it is closed.

In manual lock mode (without [#] button)

While the door is closed, touching the keypad with a hand will lock the door.

In manual lock mode (with [#] button)

While the door is closed, touching the keypad with a hand and pressing the [#] button will lock the door.

- Default setting is Automatic Lock Mode.

RFID Card Detection

- 1.
- 2.
3. * button"/>
4. * button"/>
- 5.
- 5.

- Auto detection mode is set by default.
- In the manual detection mode, touching the keypad with a hand and putting the RFID card on the reader will open the door.

Interlock/Remote Control

The interlock/remote is sold separately

Register an Interlock/Remote Control

1. Enter the **Registration Mode**
2. Press the [OPEN] button
- 3.

- Repeating steps 2 before step 3 will register another interlock / remote control. (Up to 5 devices may be registered.)

Delete an Interlock / Remote Control

1. Enter the **Deletion Mode**
2. * button"/>
3. * button"/>

- Registering a new device will automatically delete the one registered before.

How to Connect Wi-Fi Module

1. Connect the **Wi-Fi Module** into the socket.
2. Install the **Mobile App** on your phone and follow its instructions accordingly.



Delete Entire Wi-Fi Module

1. Enter the **Deletion Mode**
2. * button"/>
3. * button"/>

Troubleshooting

Problem	Solution
Product does not turn on.	Please check the direction the batteries are inserted and check polarity marking. Replace all of the batteries (alkaline). Check the battery status and/or the whether the battery is flat.
Password cannot be changed.	Touch the [Registration] button (short beep sound). Refer to How to Register and/or Change Password in the user manual.
Door does not open even after entering the password with the [*] button touched.	Check whether the password is entered correctly. If the key pad lights are out while entering the password, the buttons cannot be touched. Touch the number pad once again to light it and then enter the password once again.
Registered information can be verified with the password/RFID cards but the door does not open.	Use a 9V emergency battery (square battery) for one more attempt. The locking device may be one of the major causes of this issue; contact the service centre for assistance.
When being used, the product keeps making beeping sounds.	The alarm sound signals battery replacement. When there a beeping sound, replace all the batteries (alkaline) with new ones.
Door does not lock automatically.	Please reset to Auto Mode. When the batteries are flat, the product will make sounds but will not function. Please replace all 4 batteries (alkaline).

Automatic/Manual Lock Mode

Automatic/Manual Lock Mode

- 1.
- 2.
3. * button"/>
4. * button"/>
- 5.
- 5.

Manual Lock Mode

- 1.
- 2.
3. * button"/>
4. * button"/>
- 5.
- 5.

- Auto lock mode is set by default.
- In the initial setting of the manual lock mode, the [#] button is not enabled.
- In auto lock mode, the door will automatically be locked in 2 seconds after it is closed.
- The door will not be automatically locked in manual lock mode.

Virtual Number Function

- 1.
- 2.
3. * button"/>
4. * button"/>
- 5.

- By default, the virtual number function is activated.

Double Authorisation Mode

- 1.
- 2.
3. * button"/>
- 4.
- 5.

- Double authorisation is not enabled by default.

Volume Control

- 1.
- 2.
3. * button"/>
- 4.
- 4.

- The volume can be adjusted by to 7 levels.

Door Unlock Alarm

- 1.
- 2.
3. * button"/>
- 4.
- 4.

- Door unlock alarm is not enabled by default.
- In the door unlock the alarm mode, the alarm will go off if the door is not locked, and the display will blink for one minute.

How to use Emergency Battery

When the batteries are completely flat and the lock doesn't function, use a 9V battery for emergency entry.

1. Place the 9V battery against the 9V battery outlet.
2. Touch the number pad and then enter the password. (Touch the number pad only when the number pad is not lit.)
3. Press the [*] button and with a beep sound, the door lock will be unlocked.

