

USER MANUAL

[DIGITAL DOOR LOCK]

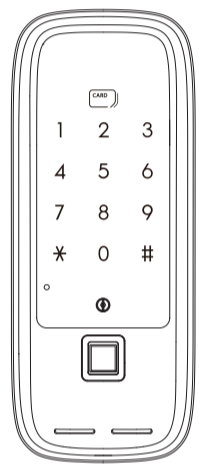

PASSWORD
SMART KEY
FINGERPRINT
(OPTIONAL) REMOTE CONTROL

The default password is 1234.
Please change to new password.
Ensure not to use consecutive or repetitive numbers for your safety.

PTSP4251ONTA REV.02

Safety Cautions

- The manual should be read thoroughly before operating the product.
- For security, the password should be changed on a regular basis.
- When the batteries are inserted in reverse positions, it may result in liquid leakage or rupture.
- When the batteries are flat, all the batteries should be replaced; please replace with new batteries; do not use used ones to replace.
- Do not install, disassemble or repair without the assistance of a product repair technician.
- Use soft and dry cloth to clean the product.
- Do not press or insert the buttons with awls or pins.
- Do not use the product for any purpose other than a digital door lock.
- Do not let water get into the product.
- This product is a household use, and cannot guarantee normal functioning in any other environment settings.
- Do not subject the product to any severe impact.

Product Components

The product components may change depending on the installation environment.

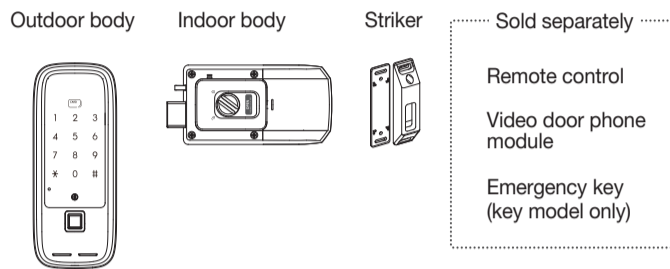

Names of Individual Parts (Outdoor Body)

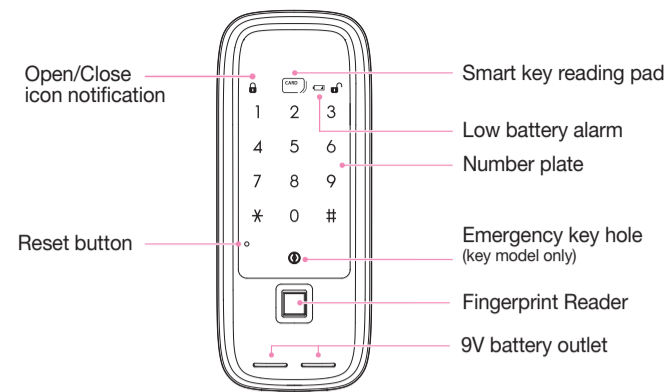

Names of Individual Parts (Indoor Body)

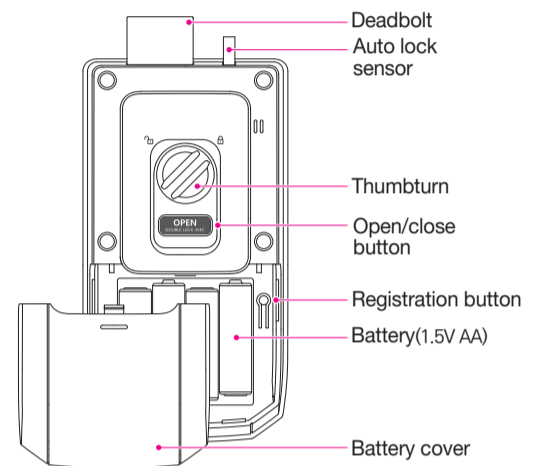

Caution

This product is a door lock without mechanical key override.
Thus, if it does not work, you can damage a part of the door lock. You need to fully understand how to use the manual locking switch to prepare for an emergency.

How to Register/Change the Password

Ensure the door is open when registering/changing the password.

1. Open the battery cover and press "Registration" button for a few seconds.



2. Check whether the lamp on the key pad is lit.



3. Enter 4~12 digits for the password.



4. Press [*] and when a beep sounds, the registration is complete.

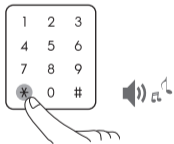

CAUTION

After the registration/change of the password, press "Open/Close" button on the inside of the door while the door is open to release the deadbolt. Enter the new password + [*] and ensure that the deadbolt retracts before closing the door. If the password is not entered within 10 seconds after the [Registration button] is pressed, the registration will be canceled. When the new password is registered, the previously registered password will be deleted automatically.

NOTE

Adding new password (up to 4 password can be added) Before the lamp on the key pad goes out, enter the new password and repeat the steps 3 and 4 as above.

How to Register/Change the Card Keys

1. Open the battery cover and press "Registration" button for a few seconds.



2. Check whether the lamp on the key pad is lit.



3. Tap the card key onto the reader. (check for a beep sound every time a new card key is registered).

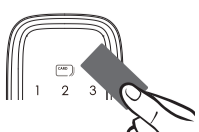

4. Press the [*] button and when a beep sounds, the registration is complete.



4

How to register the fingerprint

* Make sure to register when the door is open

1. Open the battery cover and press "Registration" button for a few seconds.



2. Place your finger on the fingerprint reader and place again after displaying the number of recognitions on the number pad (For 3 times)

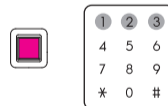

3. Press the [*] button and when a beep sounds, the registration is complete.



Before the number pad light turns off, repeat the 2nd step to continue registering fingerprints.

CAUTION

Fingerprint can be registered for 100pcs. When continue to register, the registered fingerprint will not be cancelled. When replacing the fingerprints, please delete all fingerprints first. Registration will be cancelled if there is no input for 10 secs. Injured fingerprints and children's fingerprint might be difficult to register. Please keep the fingerprint reader clean at all times.

How to Delete Card Key/fingerprint

1. Open the battery cover and press "Registration" button for a few seconds.



2. Press [8] : Delete Card Keys
Press [9] : Delete fingerprint

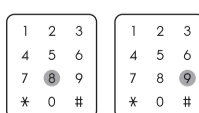

2. When the key pad on the body outside of the door is lit, press [#] button for 5 seconds.



5

Opening from Outside (with the Password)

1. Touch the key pad and then enter the password.
2. Touch [*] and after a beep sound, the door will open.

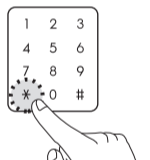

NOTE

The password needs to be entered while the light on the number plate is on, and if the key pad is unlit, touch the key pad again and enter the password once again. When an incorrect password is entered 5 times in a row, the door lock will be suspended for 1 minute with a warning sound. When the suspension is cleared, the door lock will function normally, and a correct password needs to be entered to open the door.

Opening from Outside (with Card Keys)

1. Tap the card key touch pad with a registered card key
2. Open the door after a beep sound, the door will open.

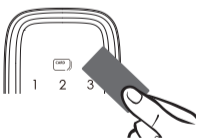

Opening from Outside (with Finger print)

- Put the registered fingerprint on the reader
Press [#] button before inputting the fingerprint, the lock will be opened silently. (for one time)



Locking from Outside

Auto lock function setting

When the door is closed, the door lock will function automatically within 2 seconds. (see page 8).



Manual lock function setting

Touch the number plate and press [#]. Then the door will be locked. (see page 8).

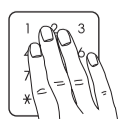

6

Open/Close door from Inside

Open door with open/close button

Close door with open/close button

OPEN/CLOSE ↑ Beep, beep

OPEN/CLOSE ↓ Beep, beep

When the door is closed, press "Open/close" button on the inside of the door and the door will open.

When the door sets manual lock function and the door is closed, press "Open/close" button on the inside of the door and the door will close.

Open door with manual thumbturn

Close door with manual thumbturn

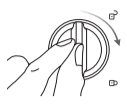
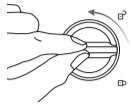

When the door is closed, turn the manual thumbturn to [] side

When the door sets manual lock function and the door is closed, turn the manual thumbturn to [] side

Locking from Inside

Automatic lock function setting

Manual lock function setting

When the door is closed, the door lock will function automatically within 2 seconds. (see page 8).

When the door is open, press "Open/close" button on the body inside of the door and the door will be locked. (see page 8).

Forced Lock Function (Outside double Lock)

This function prevents opening from inside with "open/close" button.

How activate the function

1. With the door locked, touch the key pad and enter the registered password.



2. Touch the [#] button and [0] button.



How to deactivate the function

Open door with the manual thumbturn, password, card key can deactivate the double lock function.

Forced Lock Function (Inside double Lock)

This function prevents opening from outside with either password or card keys.

How activate the function

With the door locked, press "Double Lock" button on the inside of the door for 3 seconds until a beep sounds.

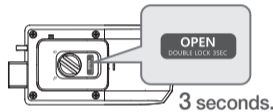

How to deactivate the function

Turn the manual thumbturn or press open/close button can deactivate the double lock function.



Deadbolt Alarm

When opening/closing the door, if the deadbolt on the inside of the door engages or does not retract properly, 3 warning beeps in a row will sound.

CAUTION Should the warning sound continue or if the product does not function properly, the position of the door lock needs to be re-adjusted. When this happens continuously, contact a door lock technician for assistance.

Low Battery Warning

When there are beeping sounds with a normal operation of the door, the batteries need to be replaced. Ensure all 4 of batteries replaced. (When the flat batteries are not replaced, the door lock will stop functioning.)

CAUTION When the batteries are flat, all of them need to be replaced. Please replace with new batteries; do not use used ones to replace. (Do not mix batteries from different manufacturers)

Use of the Emergency Battery

When the batteries are completely flat that the product cannot function properly, purchase an emergency battery (9V).

1. Connect the battery to the emergency electric power socket.
2. Touch the key pad and then enter the password. (Touch the key pad only when the key pad is not lit)
3. Press the [*] button and with a beep sound, the product will be unlocked.

Break-in Alarm

With the door locked, if the product senses any signs of abnormal attempts for opening (e.g. forcible opening), the alarm will go off with the alarm sound reaching 80db.

How to deactivate the warning alarm

Remove the batteries, enter the password or tap the card key.

High Temperature Alarm

Should the product senses a high temperature with a risk of fire (62 °C ± 5 °C), an alarm will sound in high volume to ensure safety and the door will be unlocked automatically.

CAUTION If the body on the inside of the door is exposed to direct sunlight for many hours, the temperature sensor will become active, and the alarm may go off. Even if the door is set to "Inner Double Lock Mode", the door will unlock automatically. When the product is at a high temperature, the door will not be unlocked.

Volume Control

The sound volume can be adjusted (when the door is locked).

To Increase

Touch the number plate → Password → # → 3

To Decrease

Touch the number plate → Password → # → 6

NOTE Sound volume can be adjusted to 7 levels.

Temporary Sound Pause Function

Touch the key pad on the body outside of the door, press the [#] button and then enter the password or tap with a card key for a temporary (once) sound pause.

NOTE When the temporary sound pause function is activated, the key pad will blink with each touch. Since this function is activated temporarily, the sound will return at the next use.

Automatic/Manual Lock Mode

Optional function to lock the door automatically or manually.

1. Make the deadbolt on the inside of the door engaged and touch the number pad on the outside of the door.

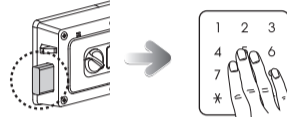

2. After enter the password, press [#] button 2 times in a row.



3. [4] button: To set the automatic lock.
[7] button: To set the manual lock.



NOTE If the manual lock function status, door doesn't lock when the door is close. Press "Open/close" button on the inside of the door or touch the key pad on the outside of the door, the door will lock.
* The auto lock function is activated when the product is purchased.

Smart Key Automatic/Manual Sensing Setting

This function is designed to sense the smart keys automatically/manually.

To set automatic sensing

Touch the number plate → Password → # Twice → 1
(Twice in a row)

To set manual sensing

Touch the number plate → Password → # Twice → 3
(Twice in a row)

NOTE With the automatic sensing setting, tag the smart key on the smart key pad to open. With the manual sensing setting, touch the number plate and then touch the smart keypad to open.
* The product is set to automatic sensing setting when the product is purchased.

Setting Video Door Phone Module and/or Portable Remote Control

This is designed to open with a video door phone module/a remote control.

How to Register

1. Open the battery cover and press "Register" button.
2. To register video door phone module: press the "Register" button.
To register the remote control: press the "Open" button (up to 5 portable remote controls can be registered)
3. Touch the [*] button on the number plate to complete.

How to Delete

1. Open the battery cover and press "Registration" button.
2. Press the [0] on the number plate.
3. Touch the [#] button for more than 5 seconds and all the registered information on the remote control will be deleted with a beep sound.



NOTE To add video door phone module and/or remote controller for registration, repeat #2 before the number plate light goes out (up to 5 can be entered).
* To use video door phone module, purchase a separate module to install.

CAUTION With registration of a new video door phone module, information of previous video door phone module will be deleted automatically. When you have installed video door phone module already, please register the existing one again. When new video door phone module and/or remote controller are not registered within 10 seconds after "Register" button pressed, the registration will be canceled.

Prank Prevention Alarm and 1-minute Suspension

When unregistered password or card keys are entered or tapped 5 times consecutively, the door will not function for 1 minute with an alarm sound.

Trouble Shooting

Trouble	Solution	Page
Product does not turn on.	Please check the direction the batteries are inserted and check polarity marking. Please replace all 4 of the batteries (alkaline). Please check the battery status and/or the whether the battery is flat.	10
Password is not changed.	Touch the "Registration" button with a short beep sound. Refer to How to Register and/or Change password in the user manual.	4
Door does not open even after entering the password with the [*] button touched.	Check whether the password is entered correctly. If the key pad lights are out while entering the password, the buttons cannot be touched; touch the key pad once again to light and then enter the password, once again.	4
Registered information can be verified with the password/card keys but the door does not open.	Use 9V emergency battery (square battery) for one more attempt. Locking device may be one of the major causes; contact the service center for assistance.	10
When being used, the product keeps making beeping sounds.	The alarming sound signals battery replacement. When there is the beeping sound, replace all the batteries (alkaline) with new ones.	10
Door does not lock automatically.	Please reset to auto mode. When the batteries are flat, the product will only make sounds but does not function. Please replace all 4 batteries (alkaline).	8, 10

Product Specification

Item	Specific ations	
Condition of Installation	Regular fire door	Door thickness: 40mm ~ 50mm
Opening Method	Password	4~12 digits (up to 4 sets can be registered)
	Card Key	No more than 100 can be registered.
Rated Voltage	DC 6V	LR6 1.5V AA size alkaline battery x 4EA
Emergency Electric Power	DC 9V	9V Battery (6LF22) (sold separately)
Weight	0.97kg (including both inner and outer bodies)	
Sensing High Temperature	Temperature	72°C±5°C (laboratory environment) / 62°C±5°C (general environment)
	sensor type	
Material	Body on the outside of the door:	Al, Zn, ABS
	Body on the Inside of the door:	Zn, ABS

* The contents of this user guide are subject to change without prior notice to the user in order to enhance performance of the product.

Memo